

MİMARİ KATALOG

ARCHITECTURAL CATALOGUE

Alüminyum Kapı Pencere ve Giydirme Cephe Sistemleri
Aluminium Window Doors and Facade Systems



R073

MİMARİ KATALOG

ARCHITECTURAL CATALOGUE

Alüminyum Kapı Pencere ve Giydirme Cephe Sistemleri
Aluminium Window Doors and Facade Systems

RO73

PROFİLLER

PROFILES

01

02

03

04

05

06

07

08

09

10

11

12

13

KOD / CODE	AĞIRLIK (kg/m) / WEIGHT	Jxx cm ⁴	Jyy cm ⁴	L m	
RO F 01	1,110	6,599	18,194	6	
RO A 01	0,208	----	----	6	
RO A 02	0,271	----	----	6	
RO A 03	0,234	----	----	6	
RO A 05	1,214	----	----	6	

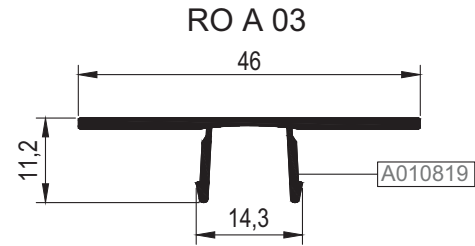
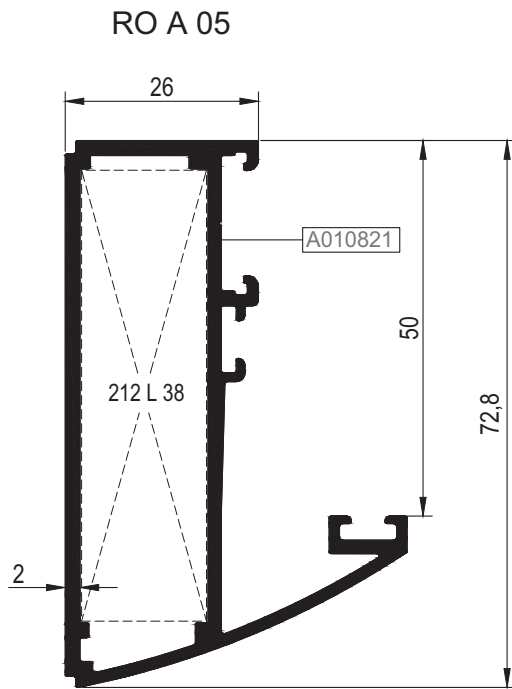
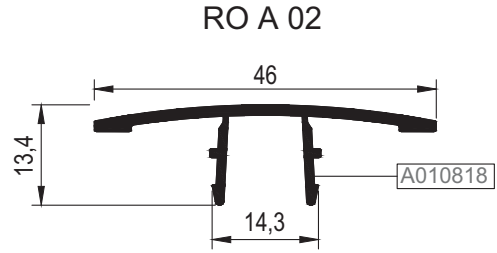
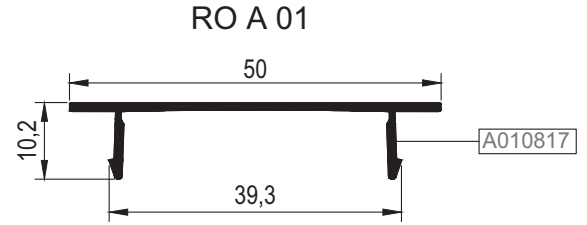
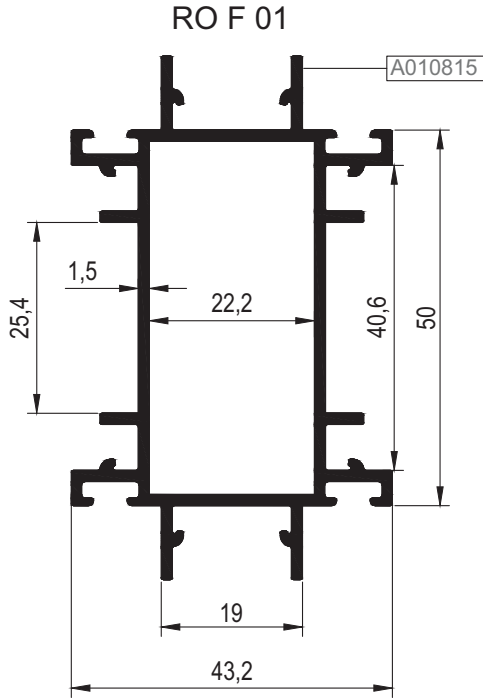

Nr		L m	KESİM ÖLÇÜSÜ CUTTING SIZE	AKS. KODU ACS. CODE
RO A 05	A010821	25 L 38 (A002074)	59,8 mm	212 L 38

KOD / CODE	AĞIRLIK (kg/m) / WEIGHT	Jxx cm ⁴	Jyy cm ⁴	L m
RO K 01	2,637	----	----	6
RO A 04	0,647	----	----	6

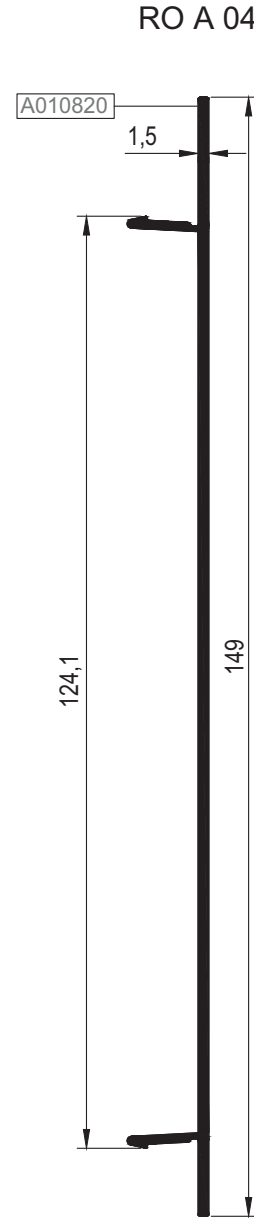
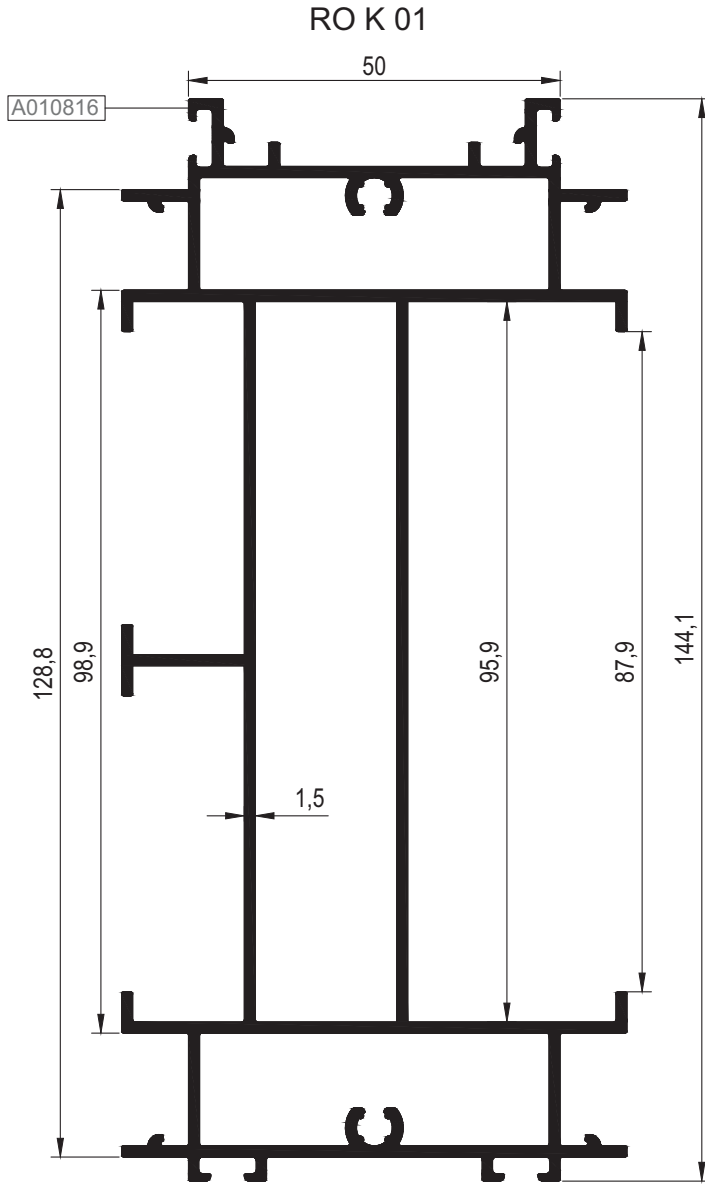

01

02

03

04

05

06

07

08

09

10

11

12

13

01

02

TAKOZLAR (CLEATS)

PROFİL KODU (PROFILE CODE)	25 L 38			
FABRİKA KODU (FACTORY CODE)	A002074			
AĞIRLIK (WEIGHT)	4,854 kg/m			
ÇİZİM (DRAWING)				

03

04

KÖŞE TAKOZLARI (CORNER CLEATS)

Nr		 L m	KESİM ÖLÇÜSÜ CUTTING SIZE	 AKS. KODU ACS. CODE
RO A 05	A010821	25 L 38 (A002074)	59,8 mm	212 L 38

05

06

07

08

09

10

11

12

13

MİMARİ KATALOG

ARCHITECTURAL CATALOGUE

Alüminyum Kapı Pencere ve Giydirme Cephe Sistemleri
Aluminium Window Doors and Facade Systems

RO73

DETAYLAR

DETAILS

01

02

03

04

05

06

07

08

09

10

11

12

13

01

02

03

04

05

06

07

08

09

10

11

12

13

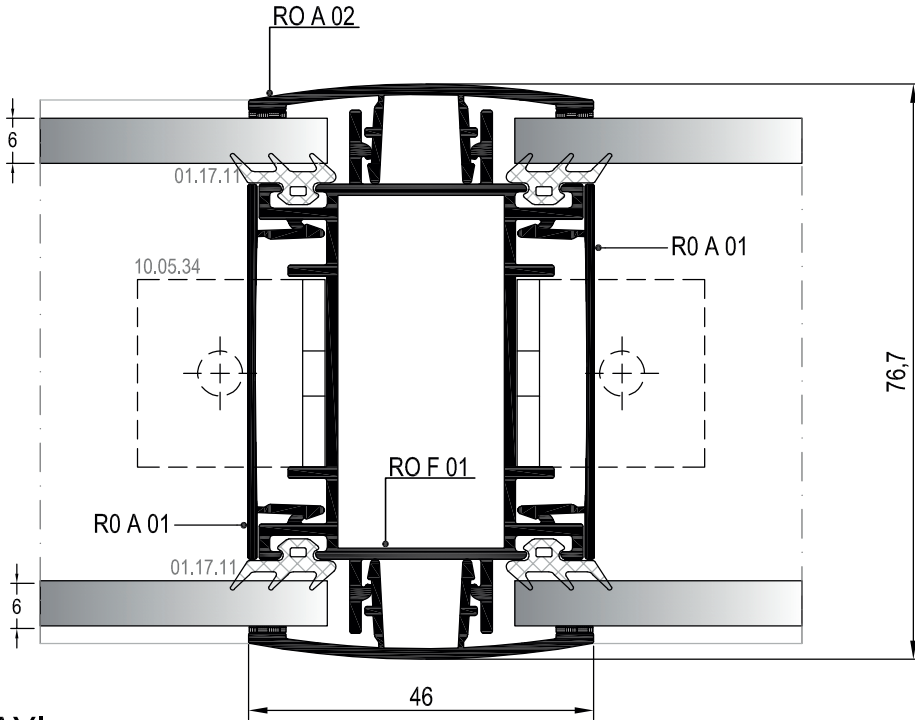
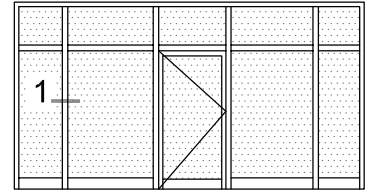

① DETAYI
DETAIL

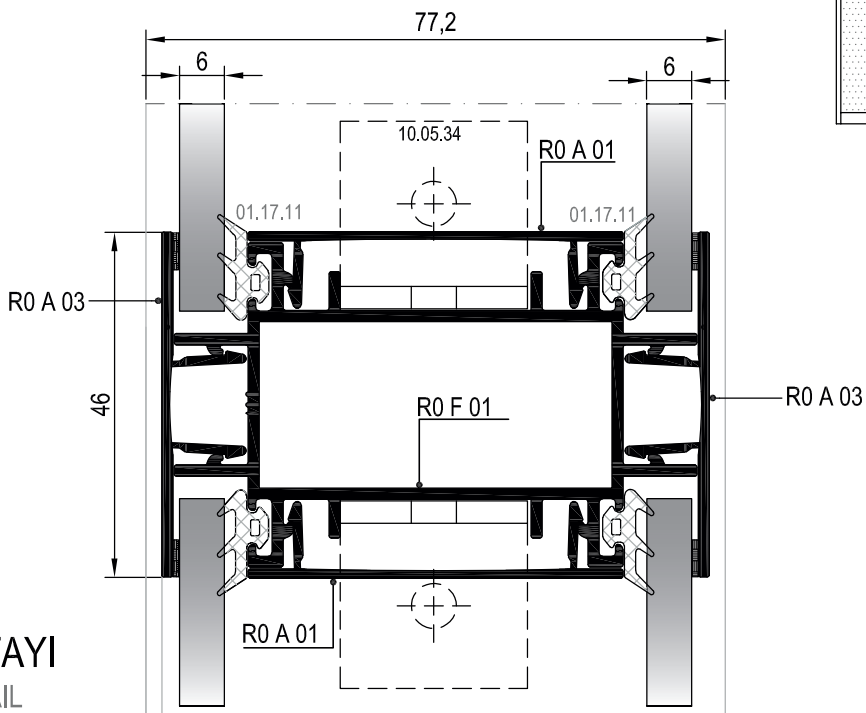
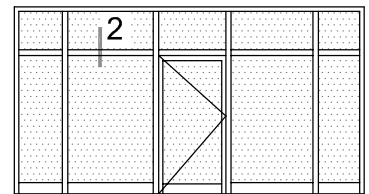

② DETAYI
DETAIL

01

02

03

04

05

06

07

08

09

10

11

12

13

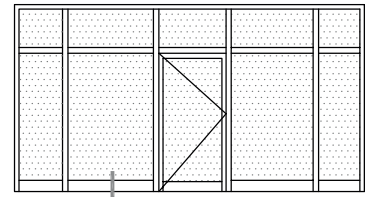

3

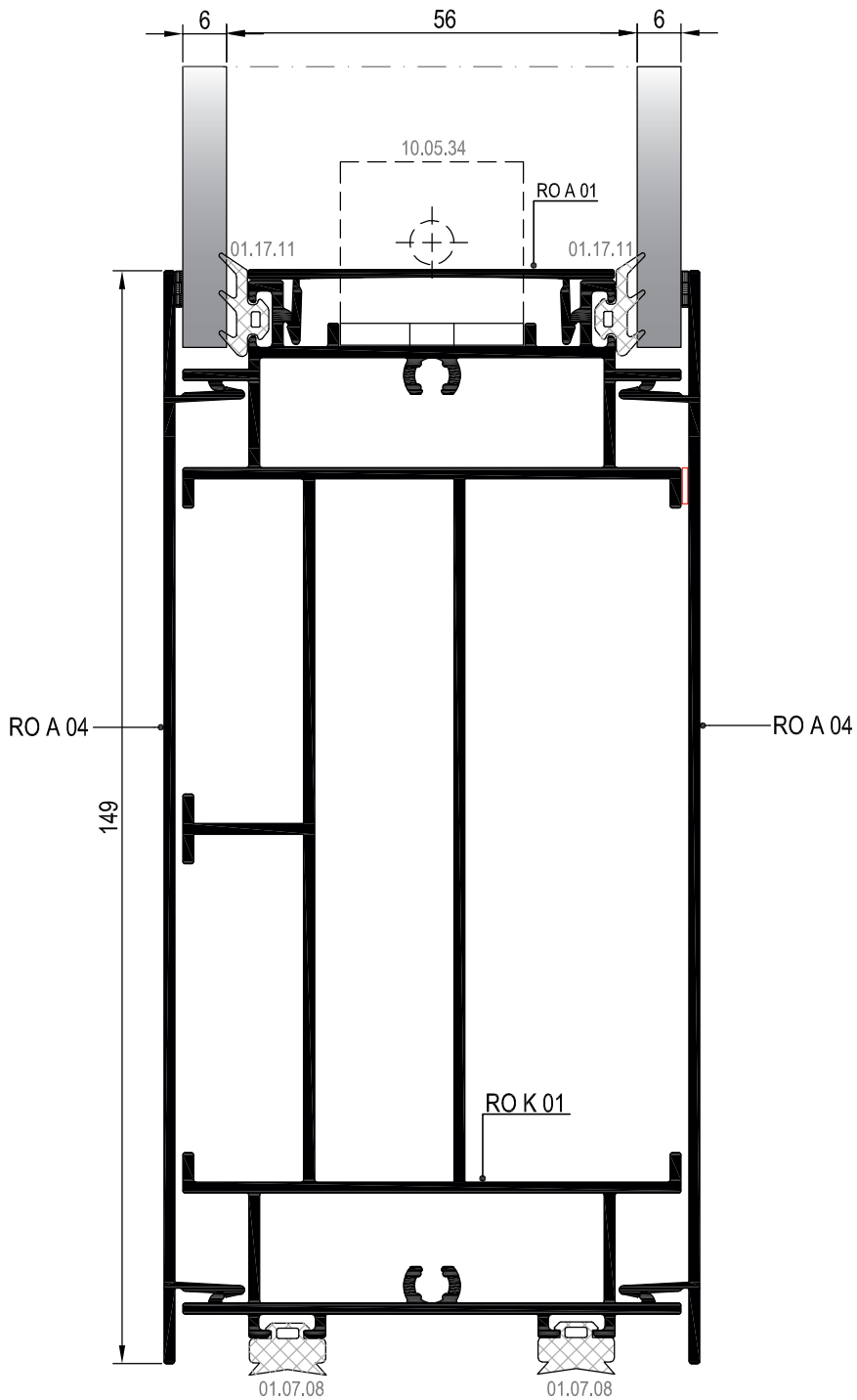

③ DETAYI
DETAIL

01

02

03

04

05

06

07

08

09

10

11

12

13

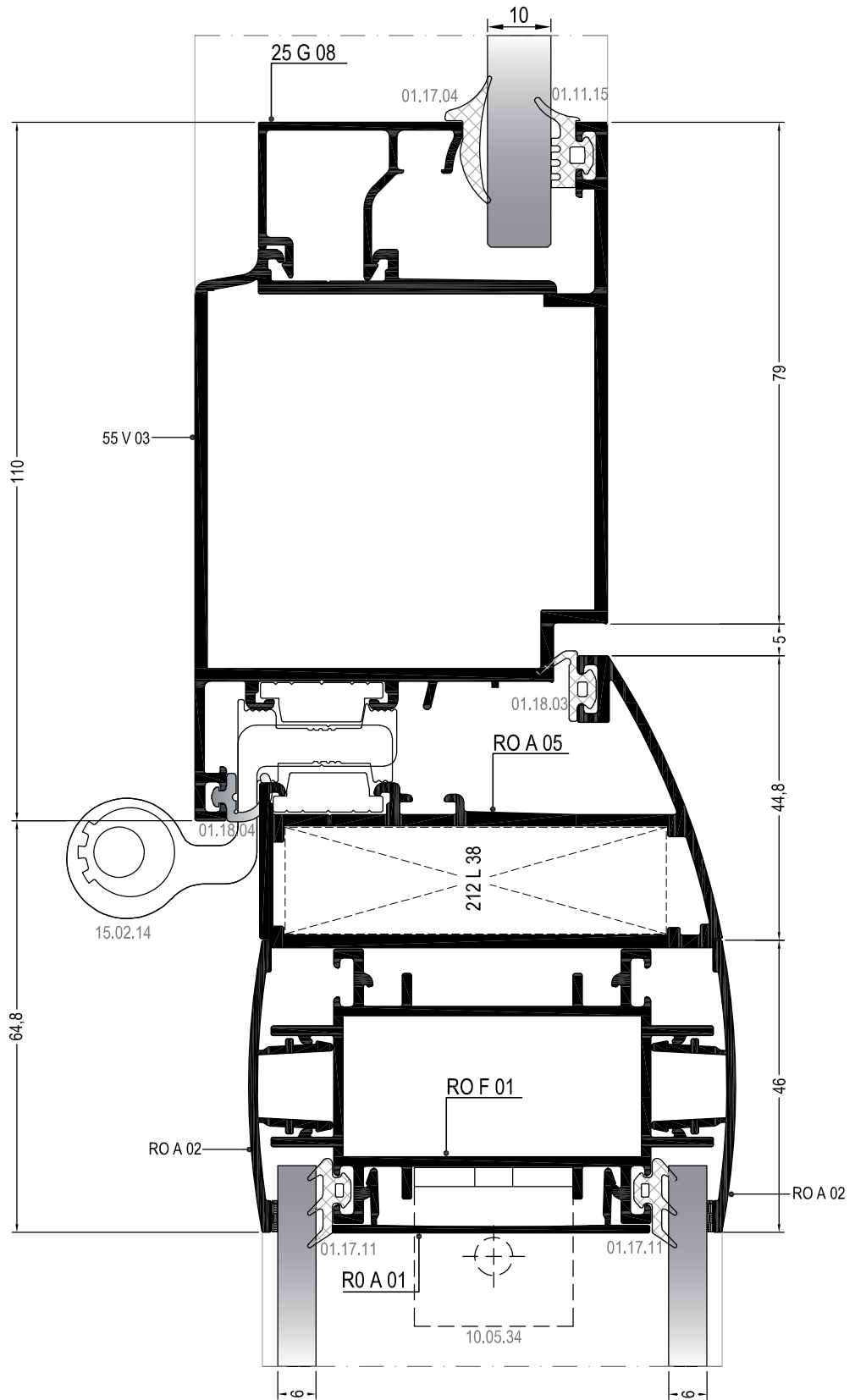
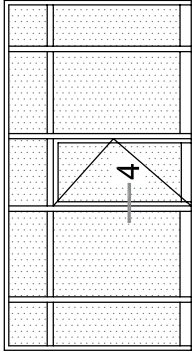

④ DETAYI
DETAIL

01

02

03

04

05

06

07

08

09

10

11

12

13

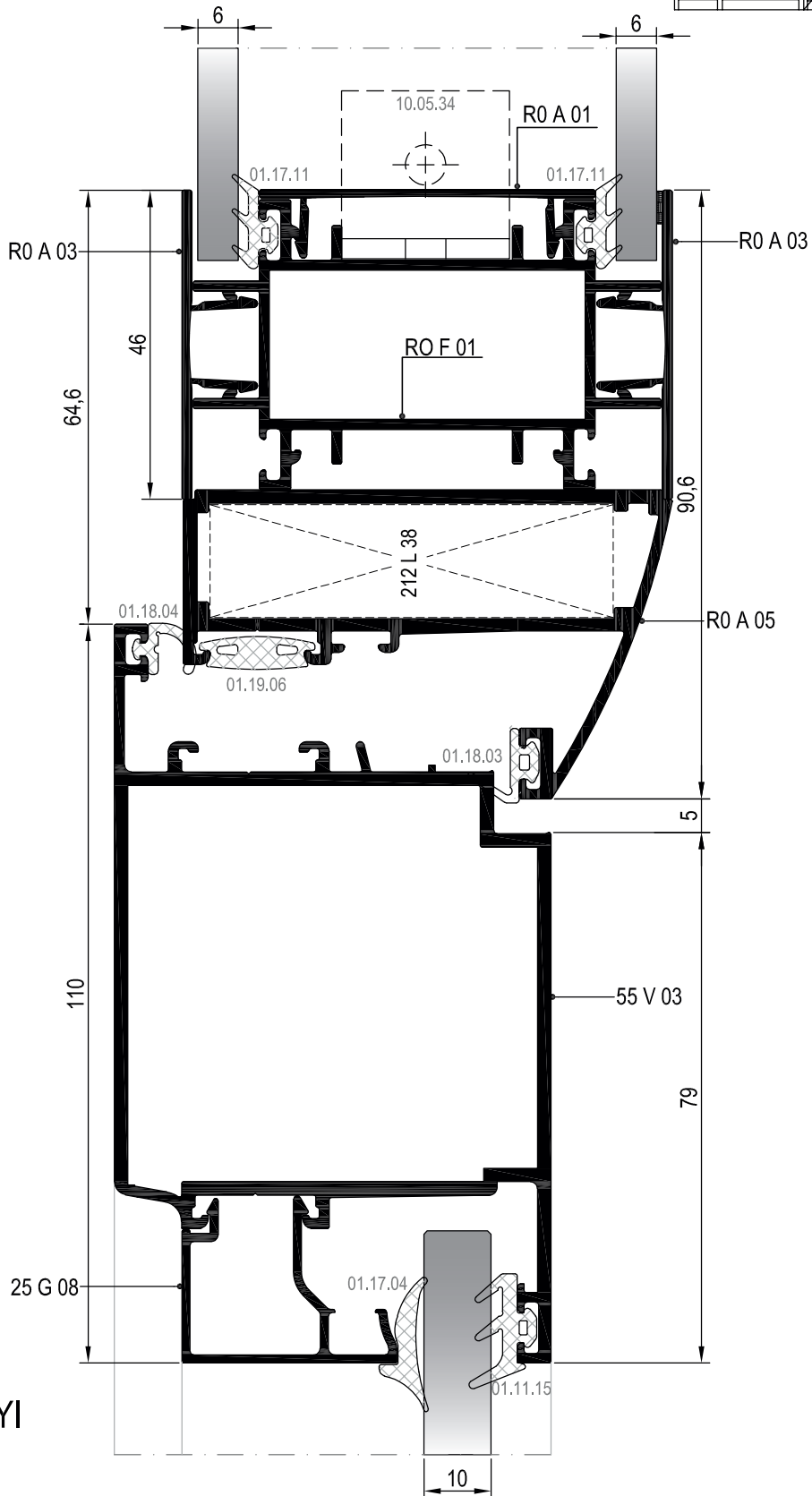
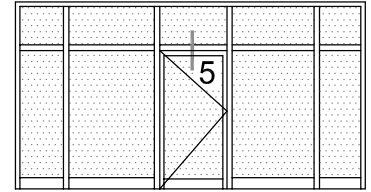

⑤ DETAYI
DETAIL

MİMARİ KATALOG

ARCHITECTURAL CATALOGUE

Alüminyum Kapı Pencere ve Giydirme Cephe Sistemleri
Aluminium Window Doors and Facade Systems

RO73

AKSESUARLAR

ACCESSORIES

01

02

03

04

05

06

07

08







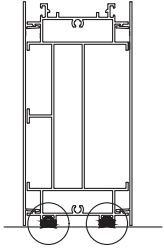

09

10

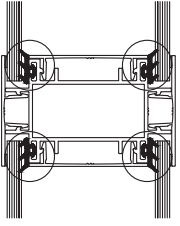
11

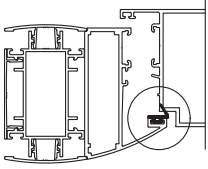
12

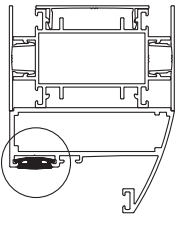
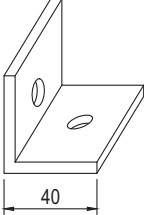
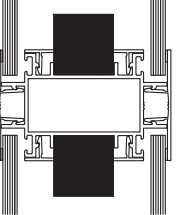
13

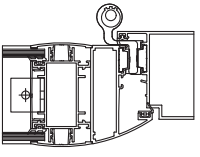
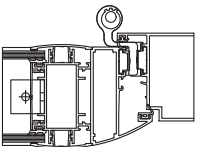
01					
02		01.07.08 ETEK ALTI FİTİLİ KICK PLATE GASKET Malzeme / Material : EPDM Ağırlık / Weight : 70 gr/m Paket / Package: 214m / 15 kg			
03					
04		01.17.11 CAM FİTİLİ GLAZING GASKET Malzeme / Material : EPDM Ağırlık / Weight : 235 gr/m Paket / Package: 63,8 m / 15 kg			
05					
06		01.18.03 DIŞ BİNİ FİTİLİ OUTSIDE ACOUSTICAL GASKET Malzeme / Material : EPDM Ağırlık / Weight : 41 gr/m Paket / Package: 365 m / 15 kg			
07					
08		01.19.06 ÇITA KANAL FİTİLİ ADAPTER GASKET Malzeme / Material : EPDM Ağırlık / Weight : 80 gr/m Paket / Package: 185 m / 15 kg			
09		10.05.34 BAĞLANTI PARÇASI CONNECTION PIECE ALÜMİNYUM 25 mm			
10		15.02.09 YERLİ KAPI MENTEŞESİ LOCAL HINGE FOR DOORS Renk: Siyah-Beyaz-Gri-Eloksal Color: Black-White-Grey-Anodised 85kg için 3adet kullanılmalıdır./Should be used 3 for 85kg. Max.kanat ölçüsü 900x2200./Max.vent dimension 900x2200			
11					
12		15.02.14 GIESSE KAPI MENTEŞESİ GIESSE HINGE FOR DOORS Renk: Siyah-Beyaz-Gri-Eloksal Color: Black-White-Grey-Anodised 100kg için 2adet, 120kg için 3adet kullanılmalıdır./Should be used 2for 100kg, 3for 120kg. EN 1935			
13					